

Brass Ferrule Regulator for Water in House Service Connection

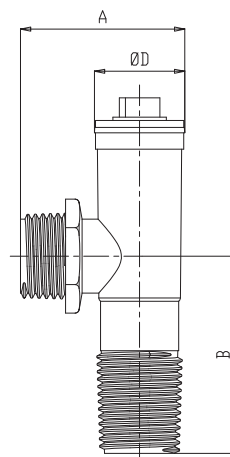

Nominal size	ID mm	Product Code	SP	g	A	B
1/2"	15	BRASSREGFERRULE050	240	137	40	48
3/4"	20	BRASSREGFERRULE075	50	394	50	73
1"	25	BRASSREGFERRULE100	35	415	53	77
1 1/4"	32	BRASSREGFERRULE125	-	-	57	83
1 1/2"	40	BRASSREGFERRULE150	25	-	68	96
2"	50	BRASSREGFERRULE200	25	-	74	104

Note: SP= Standard Pack Quantity, g = Weight in Grams

Kimplas Brass Ferrule Regulator is manufactured in Brass. The Brass Ferrule can be directly fitted on KIMPLAS DI Saddle or PE Electrofusion Branch Tapping Saddles.

Standards:

- Material complies with IS 319 Grade 1/2.
- Compatibility - DI Saddle, PE Electrofusion Branch Tapping Saddles
- Connection Threading - IS: 554 BSPT, ISO:7 -1

Common Applications:

- ✓ Regulating Water supply for House Service Connection (HSC).
- ✓ For maintaining uniform pressure for water distribution networks on undulating terrain

Installation :

Joint preparation must be done as specified in the installation instructions. First Hand tighten only then Use pipe wrench for proper tightening, Use sealants such as "Teflon Tape", "Safeda", "Hold Tight", Threads (Jute fibres) etc. wherever required. Complete Installation Instruction Manual may be downloaded.

Advantages :

- Built in regulator for regulation of flows of water
- Pressure Rating - PN 10
- Easy to joint saves time on site
- No leakage
- Long Life
- Available in standard sizes

