

ELECTROFUSION I.C. REDUCER

For Gas/Water-SDR 11 (ISO S5)

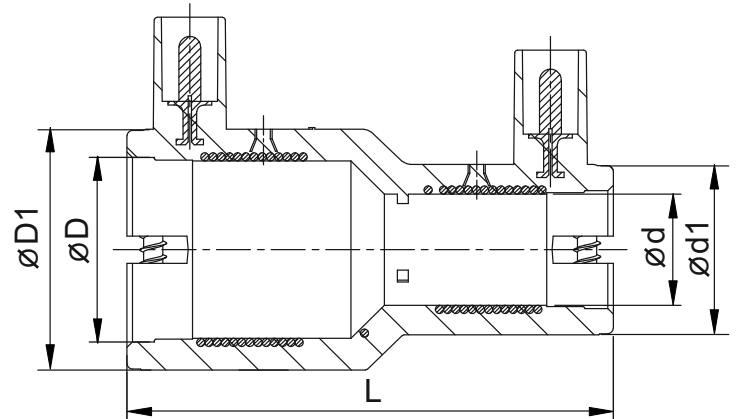

Kimplas Electro-fusion reducers are manufactured in PE 100 Black material and are of SDR 11 rating (PN 16). For exact recommendations on compatibility, for welding with SDR 9 through SDR 21 or PN 6 through PN 16 pipe, refer Kimplas Technical Specifications Manual. Kimplas Electrofusion fittings are suitable for permanently connecting MDPE 80 and PE 100 pipes, both in straight form as well as coiled form.

SPECIFICATION TABLE

Dxd	Product Code	SP	Weight (gm)	D1 (mm)	L (mm)	d1 (mm)	FT	CT
25X20	R25X20BKD	140	62	36	87	31	26	4
32x20	R32X20BKD	120	75	44	89	31	34	4
32x25	R32X25BKD	120	75	44	89	36	30	4
40x20	R40X20BKD	90	88	53	100	31	30	7
40x25	R40X25BKD	90	92	53	100	36	30	7
40x32	R40X32BKD	80	97	53	94	44	42	7
50x25	R50X25BKD	60	103	65	110	36	30	7
50x32	R50X32BKD	60	109	65	110	44	36	7
50x40	R50X40BKD	60	118	65	110	53	46	7
63x32	R63X32BKD	42	173	81	106	44	47	7
63x40	R63X40BKD	36	187	81	119	53	42	7
63x50	R63X50BKD	36	205	81	120	65	45	7

BKD - PE 100 Black - 4mm Pin

SP=Standard Pack Quantity, FT=Fusion Time in Seconds, CT=Cooling Time in Minutes, SP and Weight are given for reference only

Note: Every effort has been made to ensure the information in this brochure is correct at the date of issue. Kimplas operates a policy of continual product improvement and range extension, hence reserves the right to modify product specifications, without prior information, in line with market requirements.

STANDARDS

- PE Pipe Compatibility : ISO 4437, EN:1555-2, EN:12201-2, IS:4984, DIN: 8074.
- Complies with EN1555- Part 3 for Gas, EN12201- Part 3 for Water. AS/NZS 4129 for Gas & Water GIS-PL2-Part 4 for Gas

COMMON APPLICATIONS

- pipe to pipe connection during laying.
- Pipe connections in areas difficult to access, in narrow trenches.
- Repairing localised damages on pipe, connections of transition fittings, pipe stub ends etc.
- Pipe connections with spigot end fittings.
- Reinforcements of squeezed or kinked portions of permanently laid down (immovable) pipes.

INSTALLATION

Joint Preparation must be done as specified in the installation instructions. Pipe outside surface must be scraped to remove oxidized layer. Before fusing, pipe ends and inside of fittings must be cleaned to remove dirt and contamination. Complete installation Manual may be downloaded.

ADVANTAGES

- Standard Operating Voltage -40V.
- Same fusion time for various SDR and PN rated pipes.
- Higher penetration of pipe in the fittings enables proper alignment.
- Optimal fusion and cold zone for a strong and sturdy joint.
- Auto Temperature compensation for ambient conditions -5°C to +40°C.
- Pop-Up fusion indicators to indicate fusion process performance.
- Permanent Batch indicator, Fusion Time, Cooling Time, Raw Material Type and SDR marking.
- Each fitting individually packed in PE bag to protect against contamination and oxidation.
- Each fitting with water-proof bar code to automatically feed fusion data to the control-box for fusion process.

Contact Us

Kimplas Piping Systems Private Limited - A member of NORMA Group -

B-20, MIDC , Ambad, Nashik- 422010 | India | www.kimplaspiping.net
Tel : +91 253 6622701/2 | Fax: +91 253 6604710 | Email: sales.kimplas@normagroup.com

