

ELECTROFUSION REDUCER

For Gas-SDR 11 (ISO S5)

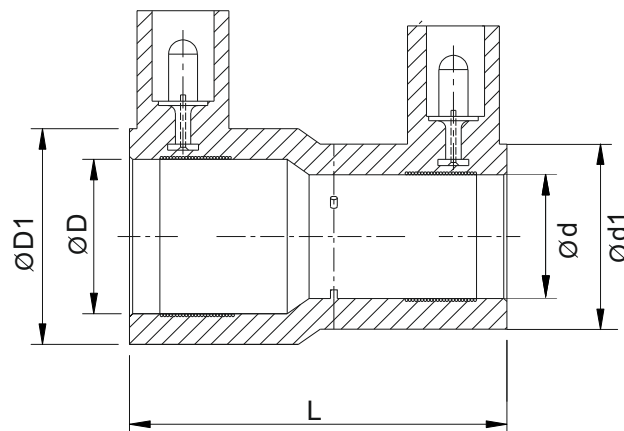

Kimplas Electrofusion Reducers are manufactured in PE 80 (Yellow) and PE 100 Black material and are of SDR 11 rating. For exact recommendations on compatibility for welding with SDR 9 through SDR 21, refer Kimplas Technical Manual. Kimplas Electrofusion Reducers are suitable for permanently connecting PE 80 pipes and PE 100 pipes, both in straight as well as in coil form.

SPECIFICATION TABLE

Dxd	Product Code	SP	Weight (gm)	D1 (mm)	L (mm)	d1 (mm)	FT	CT
25x20	R25X20BKB	140	51	37	75	31	26	4
32x20	R32X20BKB	120	64	44	82	31	34	4
32x25	R32X25BKB	120	67	44	82	37	30	4
63x32	R63X32BKB	100	88	53	94	44	42	7
40x32	R40X32BKB	42	174	81	106	44	47	7
63x40	R63X40BKB	36	174	81	115	53	42	7
63x50	R63X50BKB	36	199	81	115	65	45	7
75x63	R75X63BKB	24	263	94	120	81	90	7
90x63	R90X63BKB	14	489	113	150	81	75	15
90x75	R90X75BKB	14	451	113	200	94	100	15
110x63	R110X63BKB	8	703	137	180	81	150	15
110x75	R110X75BKB	8	627	137	160	94	150	15
110x90	R110X90BKB	8	751	137	171	113	185	15
125x63	R125X63BKB	8	928	155	200	81	95	15
125x75	R125X75BKB	8	738	155	160	94	95	15
125x90	R125X90BKB	8	987	155	200	113	140	15
125 x 110	R125x110BKBN	8	904	155	170	136	140	15

BKBN - PE 100 Black - 4mm Pin

BK8A - PE 80 Black - 4.7mm pin

YEA - PE 80 Yellow - 4.7mm Pin

BKA - PE 100 Black - 4.7mm pin

BK8B - PE 80 Black - 4mm Pin

SP=Standard Pack Quantity, FT=Fusion Time in Seconds, CT=Cooling Time in Minutes, SP and Weight are given for reference only

Note: Every effort has been made to ensure the information in this brochure is correct at the date of issue. Kimplas operates a policy of continual product improvement and range extension, hence reserves the right to modify product specifications, without prior information, in line with market requirements.

TRUSTLENE

A NORMA Group Company -
Kimplas Piping Systems Private Limited

STANDARDS

- PE Pipe Compatibility : IS:14885, ISO:4437, EN:1555-2, GIS PL 2 / 2.
- Complies with EN1555- Part 3 for Gas, EN12201- Part 3 for Water.
AS/NZS 4129 for Gas & Water GIS-PL2-Part 4 for Gas

COMMON APPLICATIONS

- Jointing of two different diameters of Pipe in mains & distribution network.
- Pipe connections in areas difficult to access in narrow trenches.
- Major use for House Service Connections, Branch Connections, Transition Fittings, Pipes Stub Ends etc.
- Pipe Connections with spigot end fittings.

INSTALLATION

Joint preparation must be done as specified in the installation instructions. Pipe outside surface must be scraped to remove oxidized layer. Before fusing, pipe ends and inside of the fittings must be cleaned to remove dirt and contamination. Complete Installation Manual may be downloaded.

ADVANTAGES

- Standard Operating Voltage -40V.
- Same fusion time for various SDR pipes.
- Higher penetration of pipe in the fittings enables proper alignment.
- Optimal fusion and cold zone for a strong and sturdy joint.
- Auto Temperature compensation for ambient conditions -5°C to + 40°C.
- Clearance-Fit for & Centre-Stop (removable) for ease of repairs.
- Pop-Up fusion indicators to indicate fusion process performance.
- Permanent Batch Indicator, Fusion Time, Cooling Time, Raw Material Type and SDR marking.
- Each fitting individually packed in PE bag to protect against contamination and oxidation.
- Each fitting with water-proof bar code to automatically feed fusion data to the Control-box for fusion process.

Contact Us

Kimplas Piping Systems Private Limited - A member of NORMA Group -

B-20, MIDC , Ambad, Nashik- 422010 | India | www.kimplaspiping.net

Tel : +91 253 6622701/2 | Fax: +91 253 6604710 | Email: sales.kimplas@normagroup.com

