

## ELECTROFUSION REDUCING TEE - HIGHER SIZE

For Gas/Water-SDR 11 (ISO S5)

Kimplas Electrofusion Reducing Tee are manufactured in PE 100 (Black) material and are of SDR 11 rating (PN 16). For exact recommendations on compatibility, for welding with SDR 9 through SDR 21 or PN 6 through PN 16 pipe, refer Kimplas Technical Specifications Manual. Kimplas Electrofusion fittings are suitable for permanently connecting PE 80 and PE 100 pipes, both in straight as well as in coil form.

### SPECIFICATION TABLE

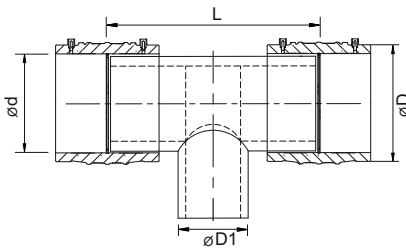

dxD1	Product Code	SP	Weight (gm)	D (mm)	L (mm)
75x63x75	RT75X63R11BKBSET	4	964	91	261
90x63x90	RT90X63R11BKBSET	4	1782	91	290
90x75x90	RT90X75R11BKBSET	4	1826	91	290
110x63x110	RT110X63R11BKBSET	3	2916	138	327
110x75x110	RT110X75R11BKBSET	3	2954	138	327
110x90x110	RT110X90R11BKBSET	3	3020	138	327
125x63x125	RT125X63R11BKBSET	3	4040	155	356
125x90x125	RT125X90R11BKBSET	3	4300	155	356
125x110x125	RT125X110R11BKBSET	3	4382	155	356
140x90x140	RT140X90R11BKBSET	3	4848	170	380
140x110x140	RT140X110R11BKBSET	3	4976	170	380
140x125x140	RT140X125R11BKBSET	3	5046	170	380
160x90x160	RT160X90R11BKBSET	3	6504	193	417
160x110x160	RT160X110R11BKBSET	3	6830	193	417
160x125x160	RT160X125R11BKBSET	3	6924	193	417
160x140x160	RT160X140R11BKBSET	3	7008	193	417
180x90x180	RT180X90R11BKBSET	3	8818	215	458
180x110x180	RT180X110R11BKBSET	3	8950	215	458
180x125x180	RT180X125R11BKBSET	3	9086	215	458
180x160x180	RT180X160R11BKBSET	3	9346	215	458
200x63x200	RT200X63R11BKBSET	2	10710	246	481
200x90x200	RT200X90R11BKBSET	2	10740	246	481
200x110x200	RT200X110R11BKBSET	2	10864	246	481
200x125x200	RT200X125R11BKBSET	2	11004	246	481
200x160x200	RT200X160R11BKBSET	2	11360	246	481
225x90x225	RT225X90R11BKBSET	2	15728	277	527
225x110x225	RT225X110R11BKBSET	2	15750	277	527
225x125x225	RT225X125R11BKBSET	2	15930	277	527
225x160x225	RT225X160R11BKBSET	2	16120	277	527
250x90x250	RT250X90R11BKBSET	1	20428	292	590
250x110x250	RT250X110R11BKBSET	1	20690	292	590
250x125x250	RT250X125R11BKBSET	1	20630	292	590
250x160x250	RT250X160R11BKBSET	1	20950	292	590
280x110x280	RT280X110R11BKBSET	1	29490	342	690
280x160x280	RT280X160R11BKBSET	1	29786	342	690
280x200x280	RT280X200R11BKBSET	1	30532	342	690
280x225x280	RT280X225R11BKBSET	1	31300	342	690
315x110x315	RT315X110R11BKBSET	1	38806	386	712
315x160x315	RT315X160R11BKBSET	1	39920	386	712
315x200x315	RT315X200R11BKBSET	1	40360	386	712
315x225x315	RT315X225R11BKBSET	1	40980	386	712
315x250x315	RT315X250R11BKBSET	1	41480	386	712

11BKBSET - SDR 11 PE 100 Black - 4mm Pin

17BKBSET - SDR 17 PE 100 Black - 4mm Pin.

Consider Fusion Time & Cooling Time as per respective size coupler

SP=Standard Pack Quantity, FT=Fusion Time in Seconds, CT=Cooling Time in Minutes, SP and Weight are given for reference only

Note: Every effort has been made to ensure the information in this brochure is correct at the date of issue. Kimplas operates a policy of continual product improvement and range extension, hence reserves the right to modify product specifications, without prior information, in line with market requirements.

## STANDARDS

- PE Pipe Compatibility : IS:14885, ISO:4437, EN:1555-2, EN: 12201-2, ISO:4427, IS: 4984, DIN:8074.
- Complies with EN1555- Part 3 for Gas, EN12201- Part 3 for Water. AS/NZS 4129 for Gas & Water GIS-PL2-Part 4 for Gas

## COMMON APPLICATIONS

- Make a branch connection on mains and distribution pipes in a distribution network.
- Taking branch connections in narrow trenches, in areas difficult to access and House Service Connections.
- Pipe Connections with spigot end fittings, pipe stub ends etc.

## INSTALLATION

Joint preparation must be done as specified in the installation instructions. Pipe outside surface must be scraped to remove oxidized layer. Before fusing, pipe ends and inside of the fittings must be cleaned to remove dirt and contamination. Complete Installation Manual may be downloaded.

## ADVANTAGES

- Fitting Pressure Rating - SDR 11 (PN16) / SDR 17.6 (PN 12.5).
- Suitable to fuse with various SDR & PN rated pipes.
- Optimal fusion and cold zone for a strong and sturdy joint.
- Tolerance fit for proper fitment with Electrofusion fittings.
- Permanent Batch Indicator, Raw Material Type and SDR marking.
- Each fitting individually packed in PE bag to protect against contamination and oxidation.

## Contact Us

**Kimplas Piping Systems Private Limited - A member of NORMA Group -**

B-20, MIDC , Ambad, Nashik- 422010 | India | [www.kimplaspiping.net](http://www.kimplaspiping.net)

Tel : +91 253 6622701/2 | Fax: +91 253 6604710 | Email: [sales.kimplas@normagroup.com](mailto:sales.kimplas@normagroup.com)

